

## DLR/DLS SLIM DISK LIGHT CCT3

PROJECT: \_\_\_\_\_

SCHEDULE: \_\_\_\_\_ DATE: \_\_\_\_\_

PREPARE BY: \_\_\_\_\_

NOTES: \_\_\_\_\_

### DESCRIPTION

Introducing our ultra-low profile selectable CCT LED downlight with matte white flange and die-cast aluminum construction for durability. This down slim light can accommodate dimmable LED lamp for delivering a light output up to 800+ lumens with 3000K, 4000K, 5000K color temperature selectable and CRI 90. The square downlight has a trim of 4-inch and 6-inch with high impact diffused lens shade for even light distribution. It is suitable for damp locations.

### APPLICATIONS

Kitchen, decoration, hallway, bedroom, ceiling mount lighting

### FEATURES

- Energy Star Qualified
- Suitable for Damp Location
- ETL listed
- IC rated
- JA9/Title 24
- Color Temperature: 3CCT(3000K, 4000K, 5000K)
- Voltage: 120V
- Surge Protection: 1KV
- Power Factor: >0.9
- Beam Angle: Flood
- Dimmable
- CRI: >90
- Operating temperature: - 4°F - 113°F
- Ultra slim design for dry wall (no recessed can needed)
- 4" / 6" square design
- Recommended ceiling height at 8-10ft
- Color: White



### EASY INSTALLATION

Snap-in mounting springs and easy wiring access for quick installation



### STYLES

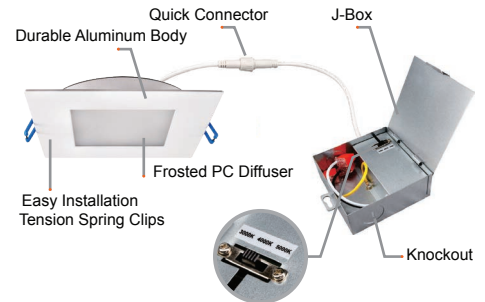

### SAMPLE NUMBER LED4DLS-60L9CCT3

STYLE	DIAMETER	SERIES	LUMENS	CRI	COLOR TEMP
LED	4	DLS	60L	9	CCT3
LED Lighting	4-inch	Slim Disk Light Square	600+ Lumens	CRI 90	Selectable Color Temperature (3000K, 4000K, 5000K)



## ORDERING

Watts (W)	Ordering Code	Description	CCT (K)	Lumens (Lm)	Size	Equiv. Wattage (W)	Damp Location	Energy Star
9	9369	LED4DLS-60L9CCT3	3CCT (3/4/5K)	600	4" Square	60	•	•
12	9371	LED6DLS-80L9CCT3	3CCT (3/4/5K)	800	6" Square	90	•	•

## ACCESSORIES (Ordered Separately)

### Plate for 4" Disk Light



P10308 PLT-NC/4DL  
(4" Round Pre-Mounting Plate)

### Plate for 3/4/6/8" Disk Light



P10375 PLT-NC-DL/3-4-6-8  
(Universal Plate for 3/4/6/8" Disk Light)

### Plate for 6" Disk Light



P10309 PLT-NC/6DL  
(6" Round Pre-Mounting Plate)

### Emergency Driver



7337 BAEM25-170BC/347-C  
(25W Micro Inverter 120-347 with 12" Conduit)

## DIMENSIONS

### 4"-Square 0.94-lbs

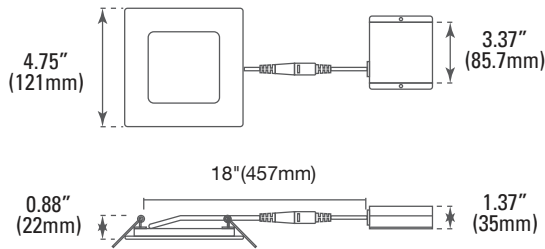

### 6"-Square 1.28-lbs

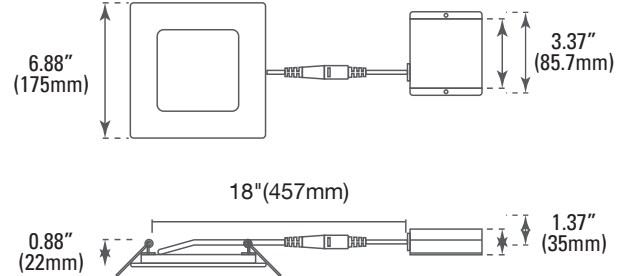

## PHOTOMETRICS CHART

### 4-inch Square Energy Star

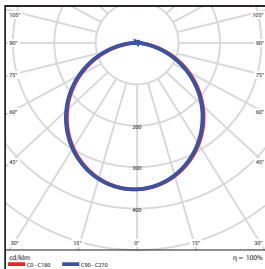

Center Beam fc	Beam Width
2.5R	96.1 fc 7.4 ft 7.3 ft
5.0R	9.03 fc 14.7 ft 14.6 ft
7.5R	4.01 fc 22.1 ft 22.0 ft
10.0R	2.26 fc 29.4 ft 29.3 ft
12.5R	1.44 fc 36.8 ft 36.6 ft
15.0R	1.00 fc 44.2 ft 43.9 ft

Vert. Spread: 111.6°  
Horiz. Spread: 111.4°

### 6-inch Square Energy Star

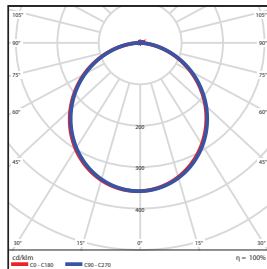

Center Beam fc	Beam Width
2.5R	49.2 fc 7.1 ft 7.1 ft
5.0R	12.3 fc 14.3 ft 14.3 ft
7.5R	5.47 fc 21.4 ft 21.4 ft
10.0R	3.08 fc 28.5 ft 28.6 ft
12.5R	1.97 fc 35.7 ft 35.7 ft
15.0R	1.37 fc 42.8 ft 42.8 ft

Vert. Spread: 109.9°  
Horiz. Spread: 110.0°

## PACKAGE

Case Qty 20 pcs

