

PROJECT:

SCHEDULE:DATE:

PREPARE BY:

NOTES:

BFS

Bullet Floodlight (1/2" Knuckle) CCT3

DESCRIPTION

The naturaLED® Bullet Flood Light (BFS) is built for landscape, security, and architectural lighting applications. With a precise 5x5 beam angle distribution, it delivers uniform illumination for enhanced visibility and safety in outdoor environments. Rated IP65, it ensures durability and reliable performance even in harsh weather conditions. The BFS features selectable wattage and color temperature (CCT), giving users flexibility to match project requirements. Its 1/2" NPT knuckle mount allows for quick installation and adjustable aiming, making it ideal for perimeters, entryways, facades, landscapes, retail centers, and residential complexes.

APPLICATIONS

Warehouses, Parking Garages, Area Lighting, Security Lighting, Pathway Lighting, Entryway Lighting



Rated Life Hours 50,000

Warranty 5 Years

FEATURES

- DLC Standard
- ETL/cETLus Listed
- Selectable Wattage & CCT
- IP65 Rated
- Wattage: 10W/15W/20W
- Color Temp: CCT3 (30/40/50K)
- Voltage: 120-277V
- Surge Protection: 2KV
- CRI: >80
- Operating Temperature: -40°F to 122°F
- Beam Angle: 5X5
- Long Life LED Chips
- 1/2" NPT Threaded Knuckle Mount
- Material: Die Cast Aluminum
- Color: Bronze
- Warranty: 5-Year Limited Warranty

SAMPLE NUMBER		BFS20S/55/8C3/BZ/PHO-KNC				
SERIES	WATTAGE	BEAM ANGLE	CRI/COLOR TEMP	COLOR	ACCESSORY	MOUNTING
BFS	20S	55	8C3	BZ	PHO	KNC
BulleFloodlight	20 Selectable Wattage	Type 5X5	CRI 80 CCT3 (30/40/50K)	Bronze	Photocell	Knuckle Mount



BULLET FLOODLIGHT CCT3

FLOODLIGHTS & AREA LUMINAIRES

*P= Premium DLC / *S = Standard DLC

ORDERING

Ordering Code	Description	Watts (W)	Lumens (Lm)	CCT (K)	Equiv. Wattage (W)	Voltage	IP65 Rated	DLC (S/P)
9798	BFS20S/55/8C3/BZ/PHO-KNC	10	1,050	CCT3 (30/40/50K)	100-150W	120-277V	•	S
		15	1,575					
		20	2,100					

PACKAGE

Master Carton (pc)	Dimensions (in)	Weight (lb)
5	18.5" x 7.68" x 8.27"	16.50

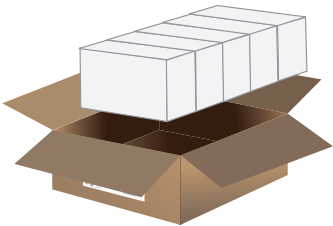

DIMENSIONS

10~20Watt
1.39-lbs

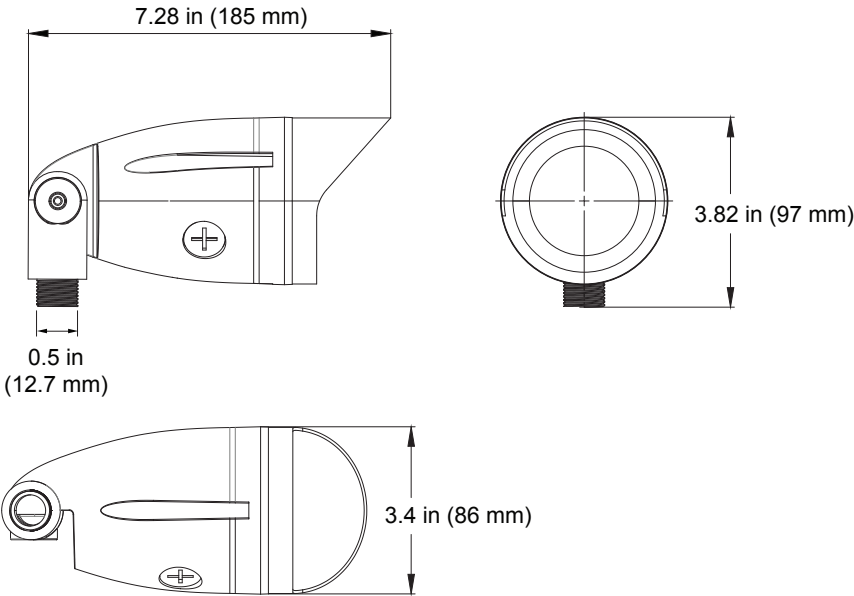

PHOTOMETRICS

10 Watt

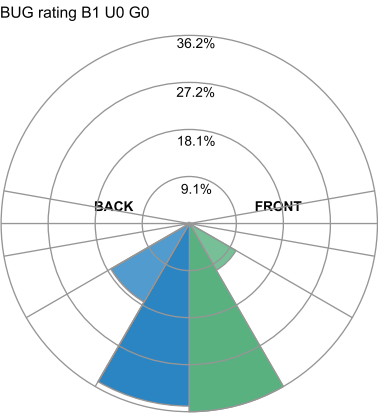
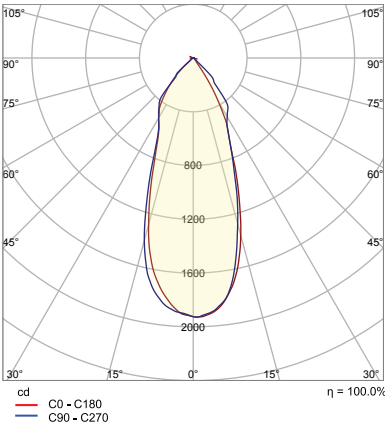

Illuminance at a Distance			
	Center Beam fc	Beam Width	
2.50M	28.6 fc	1.74 M	1.76 M
5.00M	7.15 fc	3.49 M	3.51 M
7.50M	3.18 fc	5.23 M	5.27 M
10.00M	1.79 fc	6.97 M	7.03 M
12.50M	1.14 fc	8.72 M	8.78 M
15.00M	0.79 fc	10.46 M	10.54 M

■ Vert. Spread: 38.4°
■ Horiz. Spread: 38.7°

15 Watt

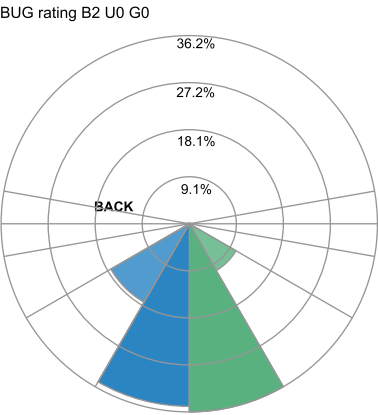
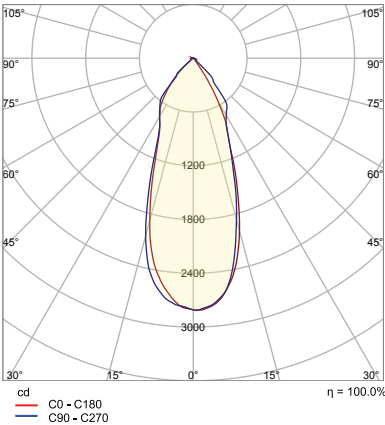

Illuminance at a Distance			
	Center Beam fc	Beam Width	
2.50M	41.8 fc	1.74 M	1.76 M
5.00M	10.4 fc	3.49 M	3.51 M
7.50M	4.64 fc	5.23 M	5.27 M
10.00M	2.61 fc	6.97 M	7.03 M
12.50M	1.67 fc	8.72 M	8.78 M
15.00M	1.16 fc	10.46 M	10.54 M

■ Vert. Spread: 38.4°
■ Horiz. Spread: 38.7°

20 Watt

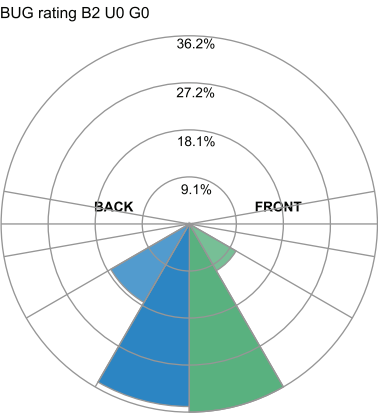
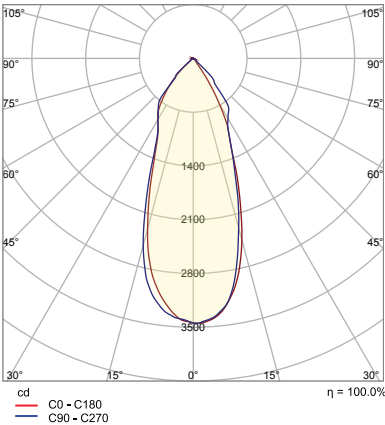

Illuminance at a Distance			
	Center Beam fc	Beam Width	
2.50M	51.2 fc	1.74 M	1.76 M
5.00M	12.8 fc	3.49 M	3.51 M
7.50M	5.69 fc	5.23 M	5.27 M
10.00M	3.20 fc	6.97 M	7.03 M
12.50M	2.05 fc	8.72 M	8.78 M
15.00M	1.42 fc	10.46 M	10.54 M

■ Vert. Spread: 38.4°
■ Horiz. Spread: 38.7°